



### Features/Benefits

- Low profile design
- Multi-pole and multi-position
- Panel and PCB mounting
- Variety of termination styles

### Typical Applications

- CATV
- Low cost security devices
- Lawn equipment

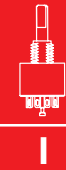

Rotary

### Build-A-Switch

Our easy Build-A-Switch concept allows you to mix and match options to create the switch you need. Below is a complete listing of options shown in catalog. To order, simply select desired option from each category and place in the appropriate box. A Switch with standard options is shown on page I-26. Available options are shown and described on pages I-26 thru I-28. For additional options not shown in catalog, consult Customer Service Center.

Typical Example: **P 1 0 0 1 3** — **3** — **W** — **M** — **0 3** — **N** — **Q** —  — **2**

#### Switch Function

- P10013** (STD.) SP, 45° Index, keypull pos. 1
- P20013** DP, 45° Index, Keypull pos. 1
- P1001U** SP, 45° Index, keypull pos. 1 & 3
- P2001U** DP, 45° Index, keypull pos. 1 & 3
- P10113** SP, 90° Index, Keypull pos. 1
- P20113** DP, 90° Index, Keypull pos. 1
- P1011U** SP, 90° Index, keypull pos. 1 & 2
- P2011U** DP, 90° Index, keypull pos. 1 & 2

#### Keying

- 3** (STD.) One nickel plated brass key
- 2** Two nickel plated brass keys

#### Type

- W** (STD.) Low profile key switch

#### Finish

- M** (STD.) Matte finish

#### Terminations

- 03** (STD.) Solder lug with hole
- 01** Solder lug with notch
- 02** PC Thru-hole
- WC** Wire lead

#### Mounting Style

- N** (STD.) With nut
- D** With clip

#### Contact Material

- Q** (STD.) Silver
- B** Gold
- G** Gold over silver

#### Seal

- NONE** (STD.) No seal
- E** Epoxy seal

#### Color

- 2** (STD.) Black
- 1** White
- 3** Red
- T** Beige

# P Series Low Profile Key Switches



## Specifications

**CONTACT RATING:** Q contact material: 4 AMPS @ 125 V AC or 28 V DC; 2 AMPS @ 250 V AC (UL/CSA). See page I-28 for additional ratings.

**ELECTRICAL LIFE:** 10,000 make-and-break cycles at full load.

**CONTACT RESISTANCE:** Below 10 milliohms typ. initial @ 2-4 V DC, 100 mA, for both silver and gold plated contacts.

**INSULATION RESISTANCE:** 10<sup>9</sup> ohms min.

**DIELECTRIC STRENGTH:** 1,000 V RMS min. @ sea level.

**INDEXING:** 45° or 90°, 2-3 positions. Other functions available, consult Customer Service Center.

## Materials

**HOUSING:** One piece, 6/6 nylon (UL94V-2), black. Finish, matte.

**KEY:** One nickel plated brass key.

**CONTACTS AND TERMINALS:** Q contact material: Copper, silver plated. See page I-28 for additional contact materials.

**CONTACT SPRING:** Music wire or stainless steel.

**TERMINAL SEAL:** Epoxy.

**NOTE:** Specifications and materials listed above are for standard switches. Detailed specifications available for these and other models, consult Customer Service Center.

## SWITCH WITH STANDARD OPTIONS

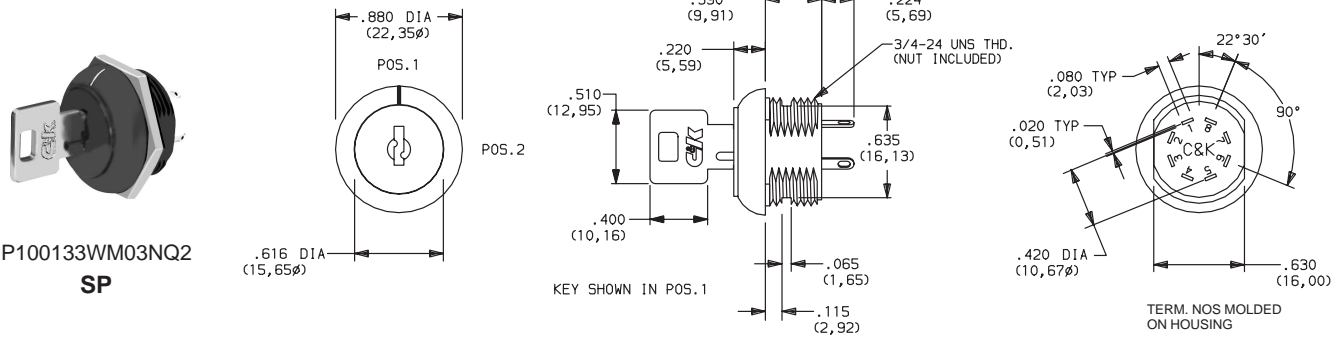

P100133WM03NQZ  
SP

PART NUMBER	NO. POSITIONS	INDEXING
<b>P100133WM03NQZ</b>	3	90°

NOTE: For panel mounting information, see page I-28.

## SWITCH FUNCTION

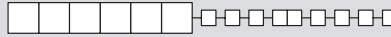

NO. POLES	MODEL NO.	CONNECTED TERMINALS (See terminal location below.)			KEY PULL POSITIONS	SWITCH CONFIGURATION	INDEXING
		POS. 1	POS. 2	POS. 3			
SP DP	<b>P10013 (STD.)</b> <b>P20013</b>	8-1 8-1, 4-5	1-2 1-2, 5-6	2-3 2-3, 6-7	Position 1		45°
SP DP	<b>P1001U</b> <b>P2001U</b>	8-1 8-1, 4-5	1-2 1-2, 5-6	2-3 2-3, 6-7	Positions 1 & 3		
SP DP	<b>P10113</b> <b>P20113</b>	8-1 8-1, 4-5	1-3 1-3, 5-7		Position 1		90°
SP DP	<b>P1011U</b> <b>P2011U</b>	8-1 8-1, 4-5	1-3 1-3, 5-7		Positions 1 & 2		

### LEGEND

- = Detent Positions (45° or 90°).
- ⊙ = Key pull possible in these positions.
- = Stop positions.

All models with all options when ordered with 'G' or 'Q' contact material.

### TERMINAL NUMBERS

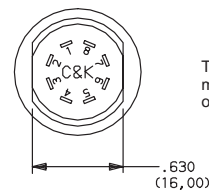

Terminal numbers molded on bottom of housing.

## KEYING

- 3** (STD.) ONE NICKEL PLATED BRASS KEY
- 2** TWO NICKEL PLATED BRASS KEYS

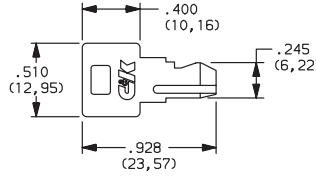

**NOTE:** All models provided with the same key code. For replacement keys or special features, consult Customer Service Center.

## TYPE

- W** (STD.) LOW PROFILE KEY SWITCH

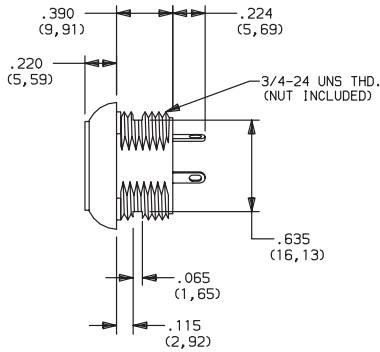

OPTION CODE	COLOR
<b>2</b>	(STD.) BLACK
<b>1</b>	WHITE
<b>3</b>	RED
<b>T</b>	BEIGE

**NOTE:** Standard housing color is black. Special colors or mixed housing and key plug colors available, consult Customer Service Center.

## FINISH

- M** (STD.) MATTE FINISH

## TERMINATIONS

- 03** (STD.) SOLDER LUG WITH HOLE

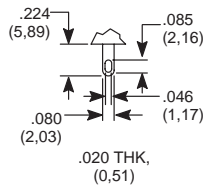

- 02** PC THRU-HOLE

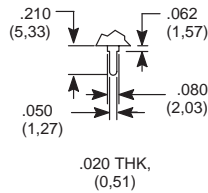

- 01** SOLDER LUG WITH NOTCH

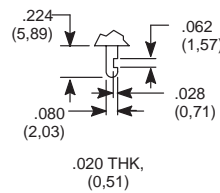

- WC** WIRE LEAD

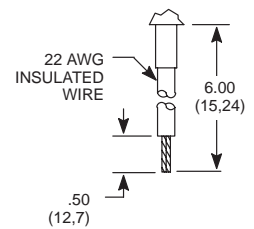

Black wire standard, other colors, gages, and lengths available, consult Customer Service Center. UL style 1015.

### PC MOUNTING

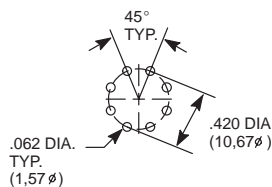

Rotary

# P Series Low Profile Key Switches



## MOUNTING STYLE

**N** (STD.) WITH NUT

**D** WITH CLIP

PANEL MOUNTING

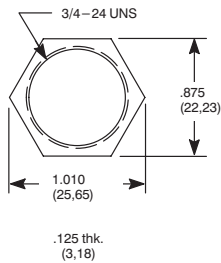

Nut part number: 175050700

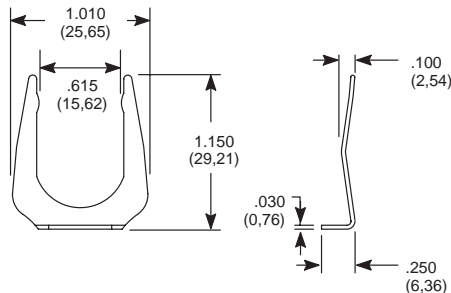

Clip part number: 175050300

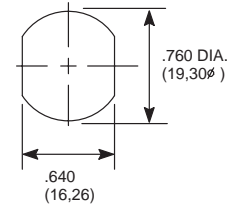

MOUNTING STYLE	PANEL THICKNESS
N (with nut)	.215 (5,46) max.
D (with clip)	.085-.105 (2,16-2,67).

## CONTACT MATERIAL

OPTION CODE	CONTACT AND TERMINAL MATERIAL	RATINGS	
		POWER	
<b>Q</b> (STD.)	SILVER <sup>2</sup>	4 AMPS @ 125 V AC OR 28 V DC; 2 AMPS @ 250 V AC (UL/CSA).	
<b>B</b>	GOLD <sup>1</sup>	LOW LEVEL/DRY CIRCUIT	0.4 VA MAX. @ 20 V AC OR DC max.
<b>G</b>	GOLD OVER SILVER <sup>3</sup>	LOW LEVEL/DRY CIRCUIT OR POWER	0.4 VA MAX. @ 20 V AC OR DC MAX. OR 4 AMPS @ 125 V AC OR 28 V DC; 2 AMPS @ 250 V AC (UL/CSA).

CONTACT MATERIAL/APPLICATION RECOMMENDATIONS — SEE CHART, PAGE L-31.

- <sup>1</sup> CONTACTS & TERMINALS: Copper, with gold plate over nickel plate.
- <sup>2</sup> CONTACTS & TERMINALS: Copper, silver plated (Standard with all termination options).
- <sup>3</sup> CONTACTS & TERMINALS: Copper, with gold plate over silver plate.

All models with all options when ordered with 'G' or 'Q' contact material.  
NOTE: 'G' contact material is equivalent to both 'B' and 'Q' contact materials.

## SEAL

**NONE** (STD.) NO SEAL

**E** EPOXY SEAL

